

### Quick Start Guide

### Part Number >> CP-871 Press / CA9 Applicator >> Setup, Loading and Operation

1- Loosen screws (2) on Reel Arm and raise the arm high enough to accommodate reel; rotate 90°. Tighten screws to secure Arm. 2- Screw the Support Posts (2) into the side of the press. 3- Place the Parts Guide over the Support Posts (2) slide to fasten, tighten knobs to secure.

4- Attach Power Cord, Foot Pedal and Tool Feed (back of press) 5- Insert Air Hose into Air Regulator on Press then connect to air sources.

#### PRESS SET-UP

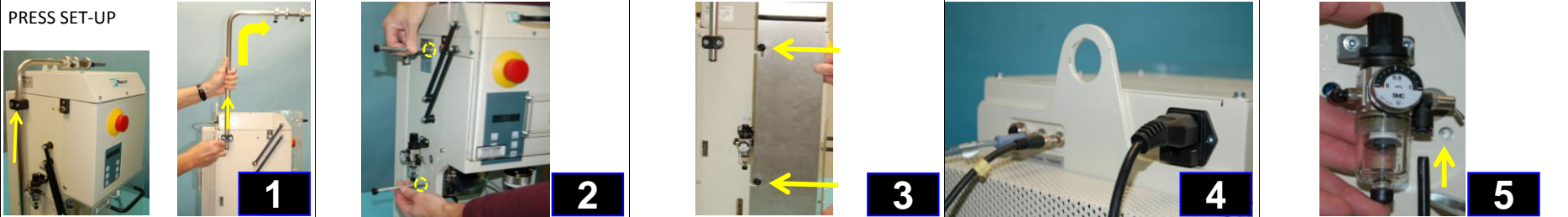

6- Use handle to Raise Safety Guard door until engaged (click sound). Make sure handle is in the down position. 7- Place the applicator on base of the press, raise ram (A), slide to the right until rams interlock and applicator hits stop (B). 8- Raise the handle on the side of the press to secure applicator.

9- Attach air line to inner fitting on press and adapter to applicator. 10- Loosen thumb screw and remove Reel Holders and spring.

#### APPLICATOR INSTALLATION

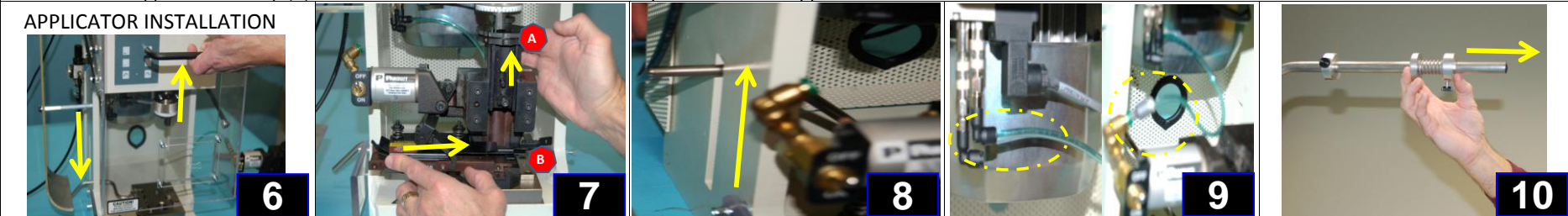

11- Place reel on Arm w/label facing outwards, tighten back Reel Stop until parts are aligned with the end of the Parts Guide. 12- Place Reel Holders onto Arm, apply pressure (compress spring) while tightening. 13- Check label for proper die set, initial setting and shut height. Turn dial to adjust to initial setting.

14- Remove protective coating from dies. Insert Crimp Die into the ram then the Cutter Die. 15- Slide the cutter die upwards then tighten securely with allen wrench (use small end of wrench to tighten)



Fully Assembled CP-871 with CA9 Applicator

**Equipment Needed:**  
 CP-871  
 CA9 Applicator  
 Power Cord and air line  
 Terminals  
 Operation Manual

**Tools Needed:**  
 Metric Allen wrenches (Set)  
 Dial Calipers  
 Side cutters

#### Safety Equipment

Glasses 

### Quick Start Guide

Part Number >> CP-871 Press / CA9 Applicator >> Setup, Loading and Operation

- 16- Lift Feed Finger (A) and insert Lower Die (B).  
 17- Lower the Feed Finger into slot of lower die and tighten securely w/allen wrench.  
 18- Turn air onto the press. Air Regulator gage should read 0.6.  
 19- Close Safety Guard. Power ON press by turning the Emergency Stop clockwise until button releases and pops outward.  
 20- Place solder slug into die area over lower die and press foot pedal.

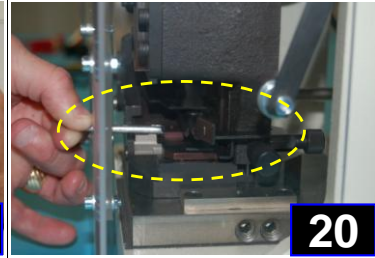
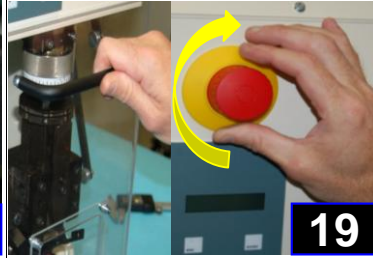
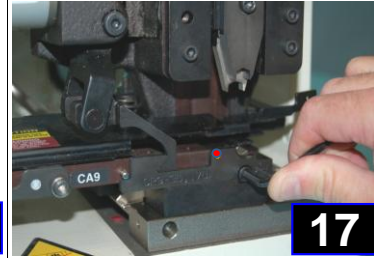
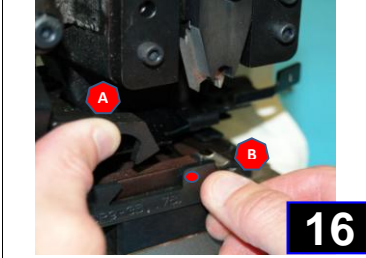

- 21- Measure crimp indentation w/caliper to determine shut height. Refer to Oper. Manual for variances.  
 22- Raise Safety Guard. Place the #1 Parts Pusher in rear position.  
 23- Lift track cover (A) and make sure toggle switch is in the OFF position (B).  
 24- Unwind terminals from spool & feed them through parts guide & into the track.  
 25. Slide terminals into track lift Feed Finger until the first part goes past the finger and is on the right side of it.

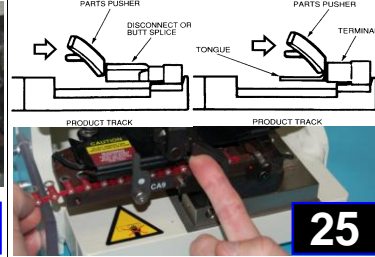
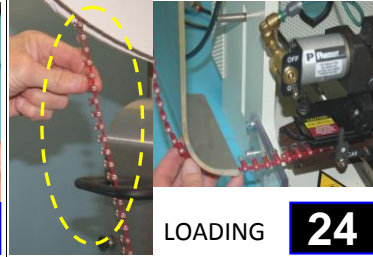
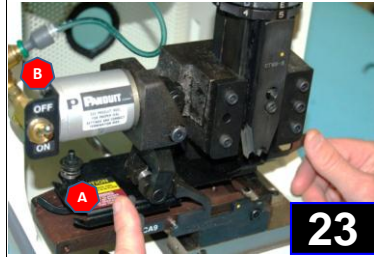
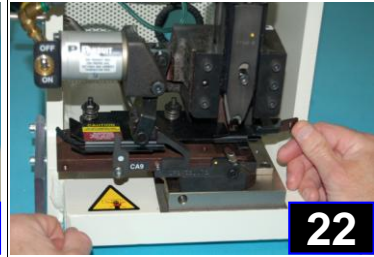
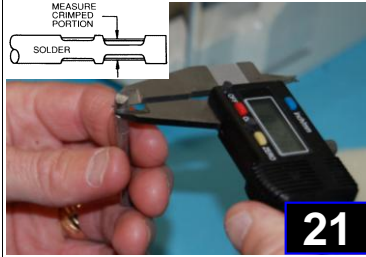

- 26- Place the #1 Part Pusher in the forward position.  
 27- Flip #2 Track Cover down (A), toggle ON/OFF (B) twice to advance parts into the die area.  
 28- Close Safety Guard door.  
 29- Insert wire into the barrel of the terminal and press foot pedal.  
 30- Check that crimp is secure and continue with operation.

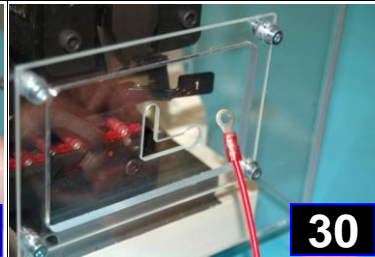
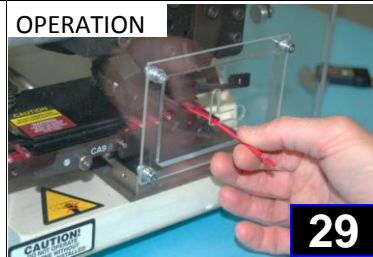
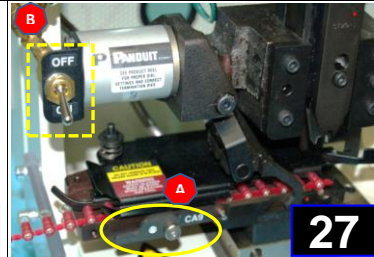
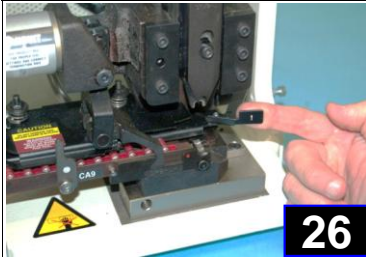

Fully Assembled CP-871 with CA9 Applicator

**Equipment Needed:**  
 CP-871  
 CA9 Applicator  
 Power Cord and air line  
 Terminals  
 Operation Manual

**Tools Needed:**  
 Metric Allen wrenches (Set)  
 Dial Calipers  
 Side cutters

**Safety Equipment**

Glasses 